

Housing Material: P250GH

Nominal diameter: DN15, DN20, DN25, DN40, DN50

Connections:

- Flanges DN 15-50, acc. DIN EN 1092-1 PN 40
- Flanges ½"-2", acc. ANSI B 16.5 Class 150 & 300
- Female thread G ½"-1" (BSP) acc. DIN ISO 228-1
- Female thread ½"-1" NPT acc. ANSI B 1.20.1
- Butt weld acc. DIN EN 12627 as ANSI B 16.25
- Socket weld acc. DIN EN 12760 as ANSI B 16.11

Nominal pressure stage: PN 40

Media: Not applicable for media of fluid group.

Application: For venting of steam chambers.

Function: Automatic venting during start-up. A temperature drop opens while an increase of temperature closes the passage. As steam temperature the valve closes.

Special characteristics: The ¾-corrosion resistant bi-metal control element forms a single item. Due to the large tolerance between valve stem and valve housing, the unit is insensitive to contamination. Valve travel can be adjusted to suit special system requirements, such as supersaturation and backpressure.

Installation: Horizontal or vertical

Design:

Max. working pressure in bar g	37	33	30	27	25
Max. working temperature in °C	100	200	250	300	350

Function limit:

max.line-pressure in bar g	24
max. temperature in °C	350

CE - Mark:

The pressure equipment described is a pressure-keeping component in accordance with the Pressure Vessel Directive 2014/68/EU article 4, subs. 3 and bears no CE-mark.

Please state the following when making inquiries / placing orders: Initial pressure, temperature and volume to be vented (Nm³/h).

Performance:

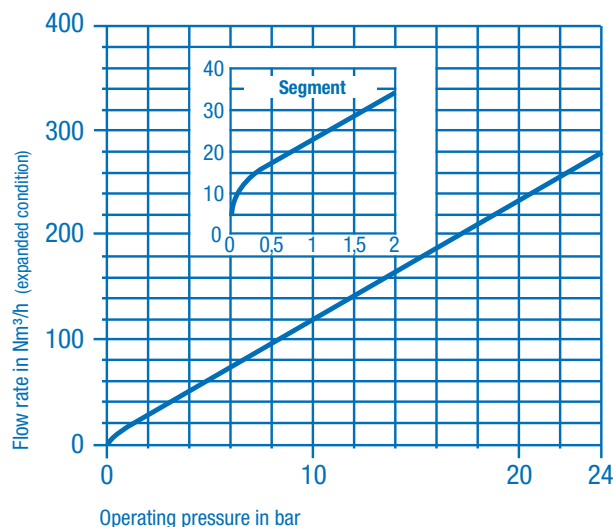

The performance diagram applies to venting in to atmosphere without backpressure. The performance values provide the quantity of air in expanded condition. To obtain the venting performance at the air under operating pressure divide the diagram values by the operating pressure in bar.



Installation Dimensions

8227

PN 40

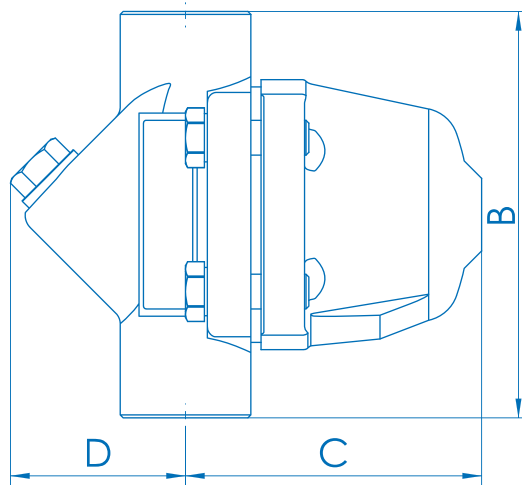
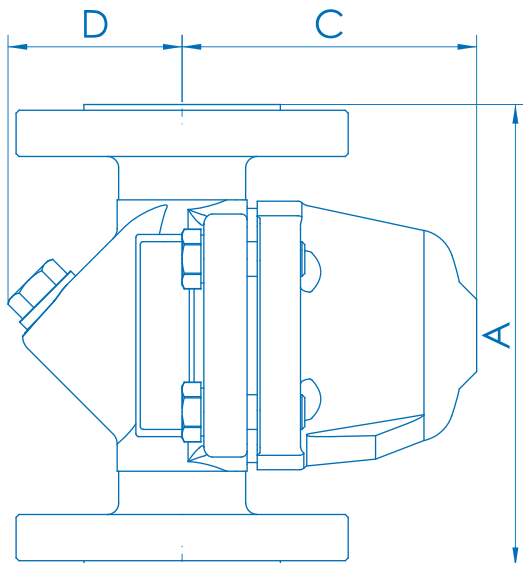

Dimensions (in mm), Weight (in kg)

Connections	Thread		BW / SW	Flanges				
	1/2"	3/4" / 1"		15	20	25	40	50
A	-	-	-	150	150	160	230	230
B	100	140	140	-	-	-	-	-
C	105	105	105	105	105	105	105	105
D	60	60	60	60	60	60	60	60
Weight	3	3,5	4	5,5	6	6,5	9	10

Spare Parts

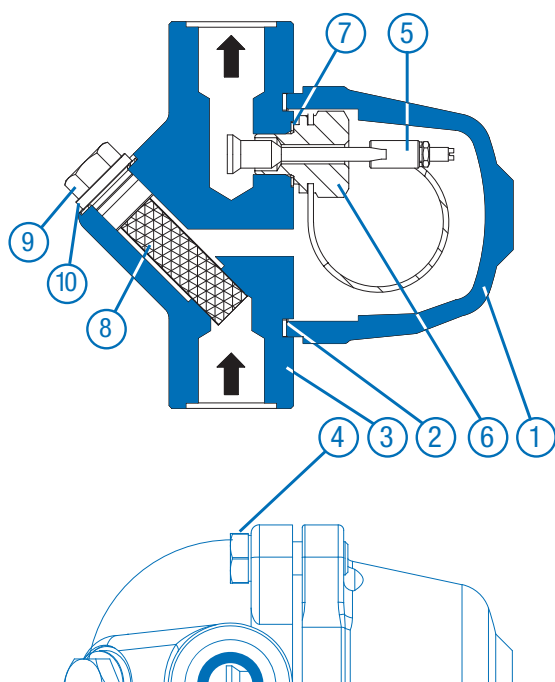

- 1 **Upper housing:** P250GH
- 2 **Housing gasket:** Novaphit
- 3 **Lower housing with flange:** P250GH
- 4 **Set Screws:** DIN 933 - A4-70 - M12
- 5 **bi-metal control complete*:**
corrosion resistant bi-metal
- 6 **Valve seat complete*:** 1.4104
- 7 **Gasket:** Soft iron
- 8 **Strainer:** 1.4301
- 9 **Screw plug:** DIN 910 - 5.8 - G 1/2" (BSP)
- 10 **Gasket:** Soft iron

* Due to sealing requirements, marked items cannot be supplied as individual parts.

To ensure correct parts delivery, specify part number and works standard sheet number 8227.