

Rp	Nb	DESIGNATION		MATIERE/MATERIAL
01	1	CORPS	BODY	1.0625/A216WCC
03	1	JOINT RACCORD SIEGE	SEAT GASKET	GRAPHITE ou/ou PTFE
04	1	RACCORD SIEGE	SEAT	1.4404/AISI 316L
08	1	SOUPAPE	DISC	1.4404/AISI 316L
09	1	DEFLECTEUR	DISC-HOLDER	1.4404/AISI 316L
10	1	VIS D'ARRET	SCREW	INOX/STAINLESS STEEL
11	1	BILLE	BALL	1.4404/AISI 316L
12	1	TIGE	STEM	1.4404/AISI 316L
14	1	GUIDE TIGE	STEM GUIDE	1.4404/AISI 316L
15	1	BAGUE COUPELLE INF.(DN40/50)	RING (ND40/50)	1.0736/AISI 1215
16	1	COUPELLE INFERIEURE	UNDER SPRING PLATE	1.0736/AISI 1215
17	1	RESSORT	SPRING	1.4310/AISI 302 ou/ou INCONEL 600
18	1	COUPELLE SUPERIEURE	UPPER SPRING PLATE	1.0736/AISI 1215
22	1	VIS REGLAGE	ADJUSTMENT SCREW	1.0736/AISI 1215
23	1	C/ECROU VIS REGLAGE	LOCK NUT	1.0060/A 288 gr C
26	1	JOINT DE BOUCHON	PLUG GASKET	GRAPHITE ou/ou PTFE
27	1	BOUCHON DN 10 à 32 DN 40/50	PLUG ND 10 to 32 ND 40/50	1.0625/A216WCC 1.0060/A 288 gr C
50	1	BRIDE TOURNANTE	LOOSE FLANGE	1.1151
51	1	RACCORD DE SORTIE	COUPLING	1.1151
52	1	BRIDE TOURNANTE	LOOSE FLANGE	1.1151
54	1	JOINT RACCORD DE SORTIE	GASKET	GRAPHITE ou/ou PTFE
55	1	VIS DE BLOCAGE	BLOCKING SCREW	INOX /STAINLESS STEEL
56	1	ECROU	NUT	INOX /STAINLESS STEEL
62	1	JOINT	GASKET	1.4301 / AISI 304L
63	1	VIS	SCREW	INOX /STAINLESS STEEL

- SOUPAPE DE SURETE ACIER CARBONE  
- BOUCHON ETANCHE SANS LEVIER  
- RACCORDEMENT ENTRE/SORTIE:  
BRIDES TOURNANTES-CLASS 150 x 150 Lbs  
-PN 40 x 16  
-CLASS 300 x 150 Lbs  
-AUTRES CONDITIONS DE SERVICE, RACCORDEMENTS ET  
MATRIEAUX SUR DEMANDE.  
-MATERIEL CONFORME A LA DIRECTIVE 97/23/CE

- CARBON STEEL SAFETY RELIEF VALVE  
- TIGHT PLUG WITHOUT LEVER  
- CONNECTIONS INLET/OUTLET  
LOOSE FLANGES-CLASS 150 x 150 Lbs  
-PN 40 x 16  
-CLASS 300 x 150 Lbs  
-OTHER WORKING CONDITIONS, CONNECTIONS  
AND MATERIALS ON REQUEST  
-MATERIAL CONFORM TO DIRECTIVE 97/23/CE

### VARIANTES OTHER POSSIBILITIES

SOUPAPE A PORTEE PTFE  
DISC WITH PTFE GASKET  
TYPE 511 ART (20 bar maxi)

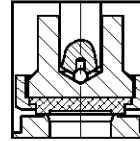

SOUPAPE A JOINT TORIQUE FPM ou EPDM  
DISC WITH O-RING FPM or EPDM  
TYPE 511 ARJT ou 511 ARJEP (20 bar maxi)

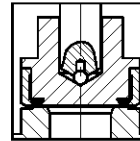

COUPELLE  
UNDER SPRING PLATE DETAIL  
DN40/50

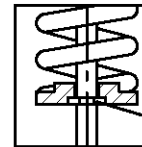

VIS DE BLOCAGE  
BLOCKING SCREW  
TYPE 511 ARVB

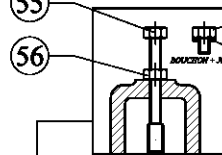

ATTENTION!

VIS DE BLOCAGE MECANISME - A REMPLACER PAR BOUCHON + JOINT AVANT MISE EN SERVICE  
BLOCKING SCREW SHOULD BE REPLACED BY SCREW+GASKET BEFORE USE

PIECES DE REMPLACEMENT RECOMMENDEES  
RECOMMENDED SPARE PARTS

CE DOCUMENT PEUT ETRE MODIFIE SANS AVIS PREALABLE  
ALL SPECIFICATIONS SUBJECT TO CHANGE WITHOUT NOTICE

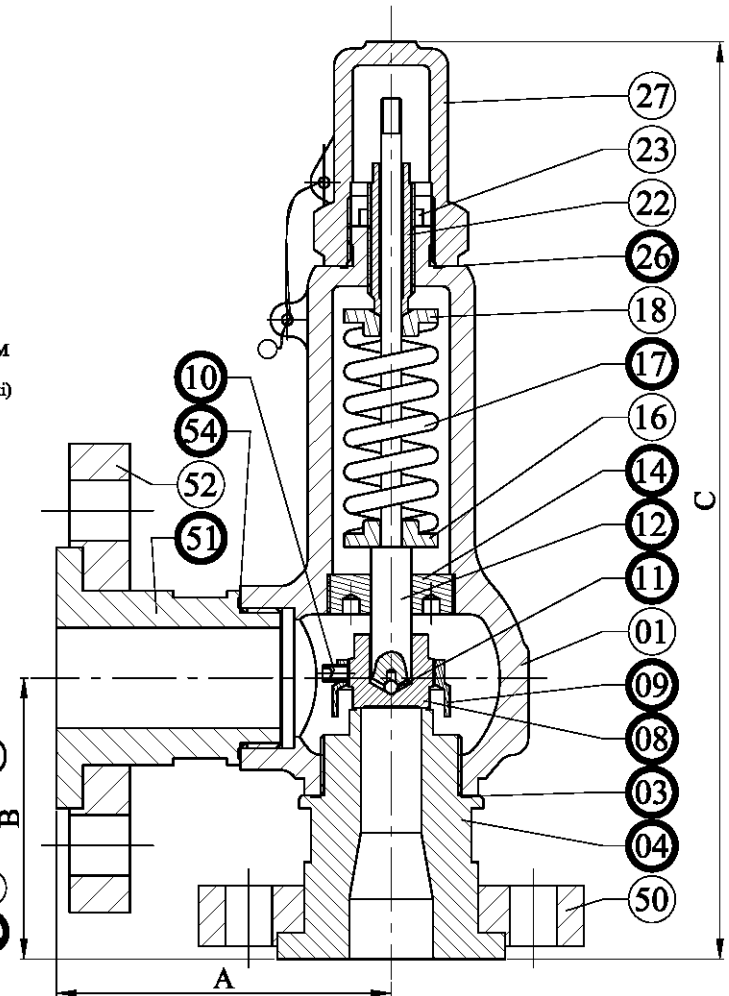

RACCORDEMENT CONNECTION				A	B	C	P.D.O (bar) SET PRESSURE MINI 0,20 bar			SECTION DE PASSAGE CROSS SECTION (mm <sup>2</sup> )	POIDS WEIGHT (Kg)
ENTREE INLET		SORTIE OUTLET					Maxi				
PN 40	300/150 Lbs	PN16	150 Lbs				Cl.150	PN 40	Cl.300		
10	20	20	20	85	72	226	20	40	45	50	3.7
15	1/2"	20	3/4"	85	72	226	20	40	45	113	3.9
20	3/4"	32	1"	100	85	273	20	40	45	177	5.1
25	1"	32	1"	100	85	273	20	37	37	254	6.6
32	1.1/4"	32	1.1/4"	100	85	273	20	27	27	346	8
40	1.1/2"	50	2"	115	115	485	20	40	40	707	18
50	2"	50	2"	115	115	485	20	27	27	1018	22

A	22/01/07	EDITION ORIGINALE / INITIAL ISSUE	RANA	DEBILLE
SOUPAPE DE SURETE SAFETY RELIEF VALVE TYPE 511 AR			3511 A	
DN 10/.../50 -PN40-CLASS300/150Lbs				